

STEMPLE W KSZTAŁCIE KWADRATU I PROSTOKĄTA PUNCHES FORM DA HEADED/HEADLESS – SQUARED AND RECTANGULAR

WYKONANIE: hartowane, odpuszczone, szlifowane

VERSION: Hardened, tempered
and fully fine ground finished

MATERIAŁ: HSS
MATERIAL: HSS

TWARDOŚĆ: 60-66 HRC
HARDNESS: 60-66 HRC

TYP CS - kwadrat
TYPE CS - square

a (-0,01)	l +0,5
1,0 do 12,0	72 mm

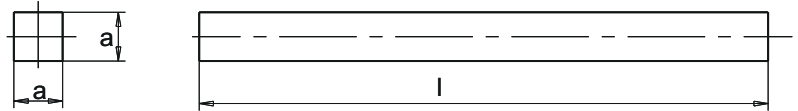

PRZYKŁAD ZAMAWIANIA: Stempel CS: a=6,0 mm
ORDER EXAMPLE: Punch CS: a=6,0 mm

Nr. katalogowy: CS-06
Order number: CS-06

TYP CC - kwadrat z łbem
TYPE CC - square headed

a (-0,01)	l +0,5
0,5 do 12,0	71 mm

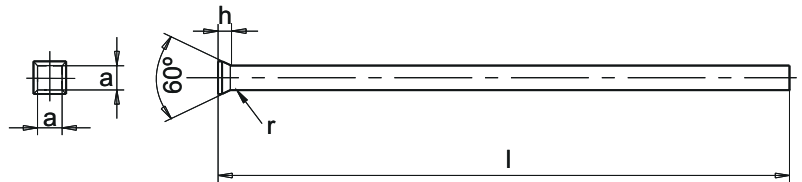

PRZYKŁAD ZAMAWIANIA: Stempel CC: a=7,0 mm
ORDER EXAMPLE: Punch CC: a=7,0 mm

Nr. katalogowy: CC-07
Order number: CC-07

TYP RS - prostokąt
TYPE RS - rectangular headless

a (-0,01)	b (-0,01)	l +0,5
1,0 do 34,0	0,5 do 12,0	71 mm

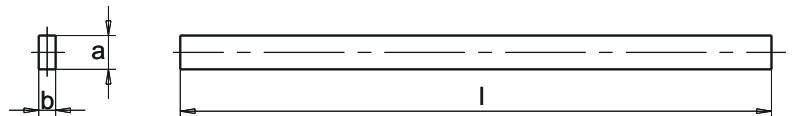

PRZYKŁAD ZAMAWIANIA: Stempel RS: a=6,0 mm
ORDER EXAMPLE: Punch RS: a=6,0 mm

b=12,0 mm
b=12,0 mm

Nr. katalogowy: RS-0612
Order number: RS-0612

TYP RC - prostokąt z łbem
TYPE RC - rectangular headed

a (-0,01)	b (-0,01)	l +0,5
1,0 do 34,0	0,5 do 12,0	71 mm

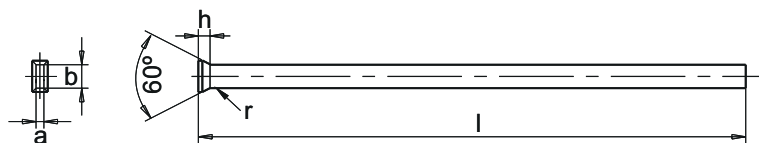

PRZYKŁAD ZAMAWIANIA: Stempel RC: a=34,0 mm
ORDER EXAMPLE: Punch RC: a=34,0 mm

b=0,5 mm
b=0,5 mm

Nr. katalogowy: RC-34005
Order number: RC-34005